

## INSTALLATION INSTRUCTIONS

Seamless Transaction with Enhanced Product Features delivered on time and quality correct.

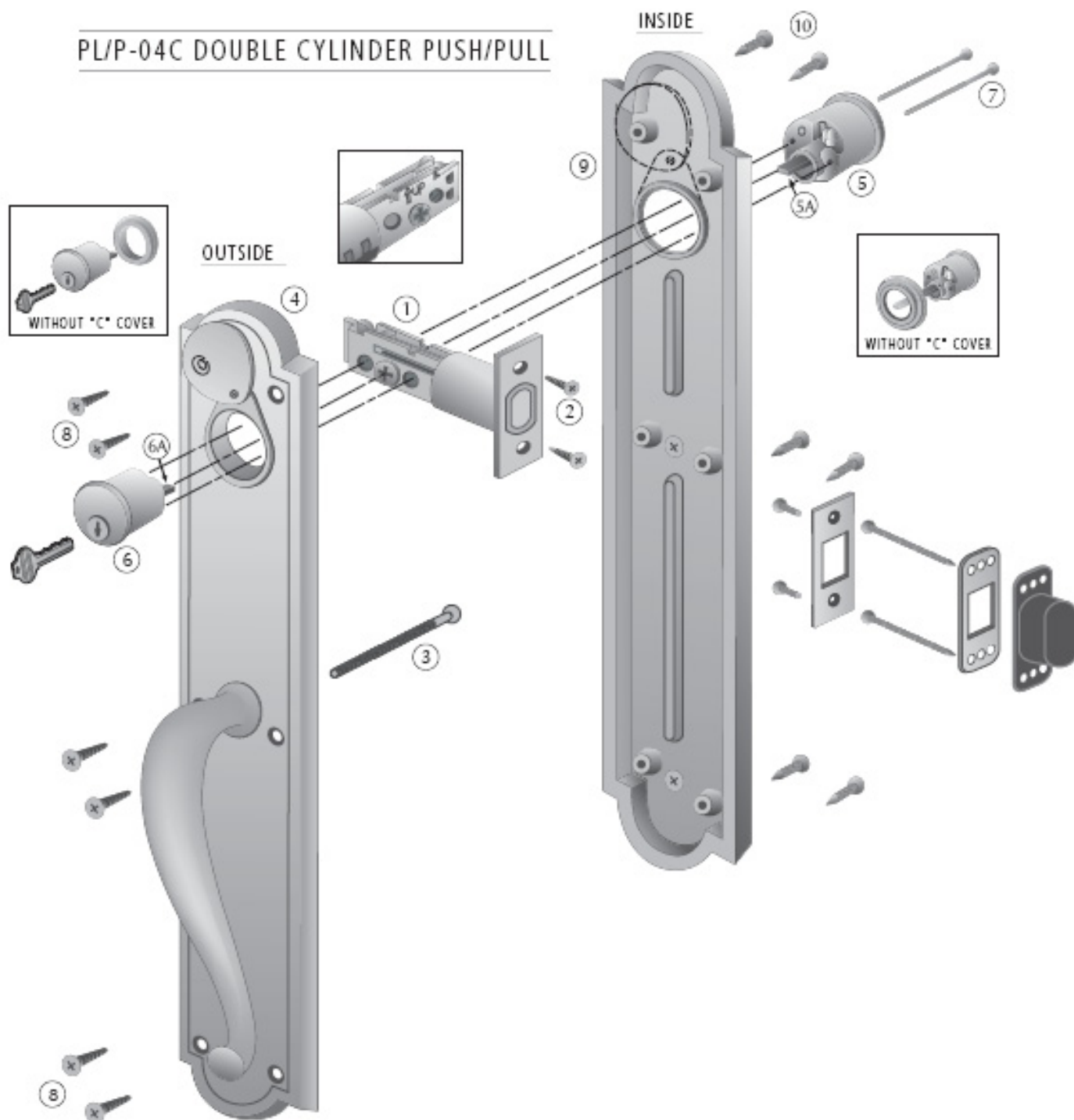



## INSTALLATION INSTRUCTIONS

Seamless Transaction with Enhanced Product Features delivered on time and quality correct.

### PL/P-04C DOUBLE CYLINDER PUSH/PULL

- A. Insert deadlatch (1) into the edge of bore. Be sure to orient latch as shown in drawing. Install using screws (2). Pre-drill for screws using a 1/8" drill-bit.
- B. Install the dustbox and strike on the jamb. Pre-drill for screws as above.
- C. Pre-drill for throughbolt (3): On a vertical line through the deadbolt bore, measure down 6-5/8" from the center of the bore. Drill through the door using a 1/4" drill-bit.
- D. Using a screwdriver or similar tool, rotate the hub of the deadbolt (1) to extend the bolt to the "out" position.
- E. Place the outside trim (4) on the door, and fasten with throughbolt (3) from inside of door, while holding the trim plate aligned parallel with edge of door. Insert the key cylinder (6) through the outside trim plate (4). (The key cylinder for outside is the one without 2 holes in the face.) Rotate the tailpiece (6A) to vertical orientation and fit into the hub of deadbolt.
- F. Slip the inside cylinder (5) through the trim plate (9), and rotate the tailpiece (5A) to vertical orientation. When fitting the tailpiece (5A) into the deadbolt hub it will overlap the tailpiece (6A) from the outside cylinder. Connect the cylinders with screws (7), passing through the inside cylinder and threading into the back of the outside cylinder. Don't tighten screws yet.
- G. Align both inside and outside plates parallel with edge of door, and position so the deadbolt operates freely by the key from either side of door. Tighten screws (7). Fasten outside plate (4) with screws (8) and inside plate with screws (10). We recommend using a #5 VIX bit to pilot the screw holes. (If you don't have one, use a 3/32" drill bit.) Hand tighten screws, as a power driver may strip them.