

# INSTALLATION INSTRUCTIONS

Seamless Transaction with Enhanced Product Features delivered on time and quality correct.

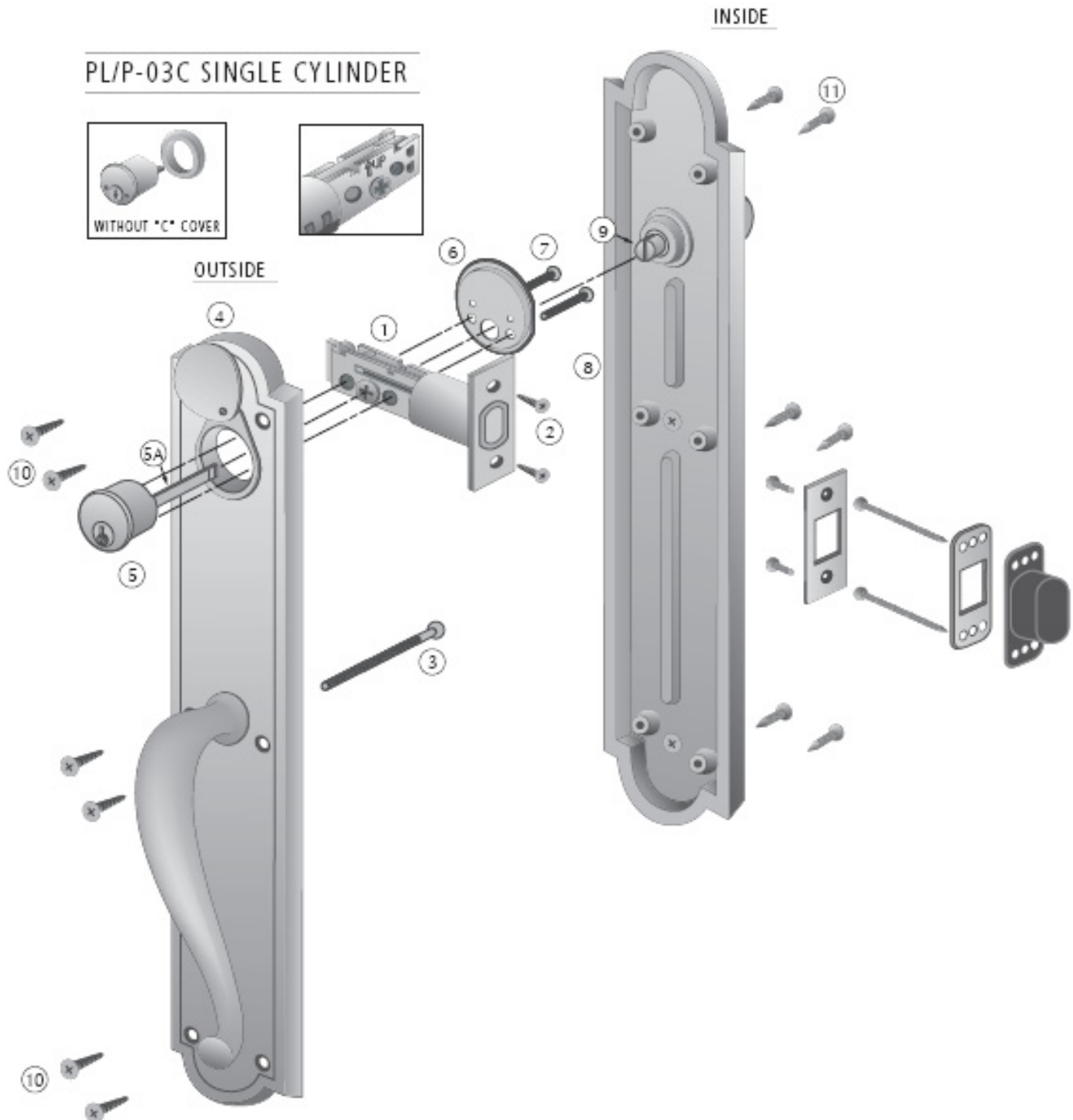

## INSTALLATION INSTRUCTIONS

Seamless Transaction with Enhanced Product Features delivered on time and quality correct.

### PL/P-03C SINGLE CYLINDER

- A. Insert deadlatch (1) into the edge of bore. Be sure to orient latch as in drawing. Install using screws (2). Pre-drill for screws using a 1/8" drill-bit.
- B. Install the dustbox and strike on the jamb. Pre-drill for screws as above.
- C. Pre-drill for throughbolt (3): On a vertical line through the deadbolt bore, measure down 6-5/8" from the center of the bore. Drill through the door using a 1/4" drill bit.
- D. Using a screwdriver, or similar tool, rotate the hub of the deadbolt (1) to extend the bolt to the "out" position.
- E. Insert the key cylinder (5) through the outside trim plate (4). Rotate the tailpiece (5A) to the vertical position and place the outside trim (4) on the door, fitting the tailpiece into the hub of deadbolt.
- F. Hold subplate (6) to inside of door, and fasten to back of cylinder (5) using machine screws (7). Don't tighten the screws yet.
- G. Insert the through-bolt (3) through the door from the inside, and thread into the outside trim plate. Align edge of plate parallel with edge of door, and position for smooth operation of deadbolt by key. Tighten screws (3) & (7).
- H. Mount outside trim (4) to door using screws (10). We recommend using a #5 VIX bit to pilot the screw holes. (If you do not have one, use a 3/32" drill-bit.) Hand tighten the screws, as a power driver may strip them.
- I. Place the inside trim (8) on the door, sliding the tailpiece (5A) into the slot in the thumbturn (9). Align the edge of trim plate with edge of door. Position trim for smooth operation of deadbolt. Fasten trim to door with screws (11). Pre-drill for screws as for outside trim above.