

INSTALLATION INSTRUCTIONS

Seamless Transaction with Enhanced Product Features delivered on time and quality correct.

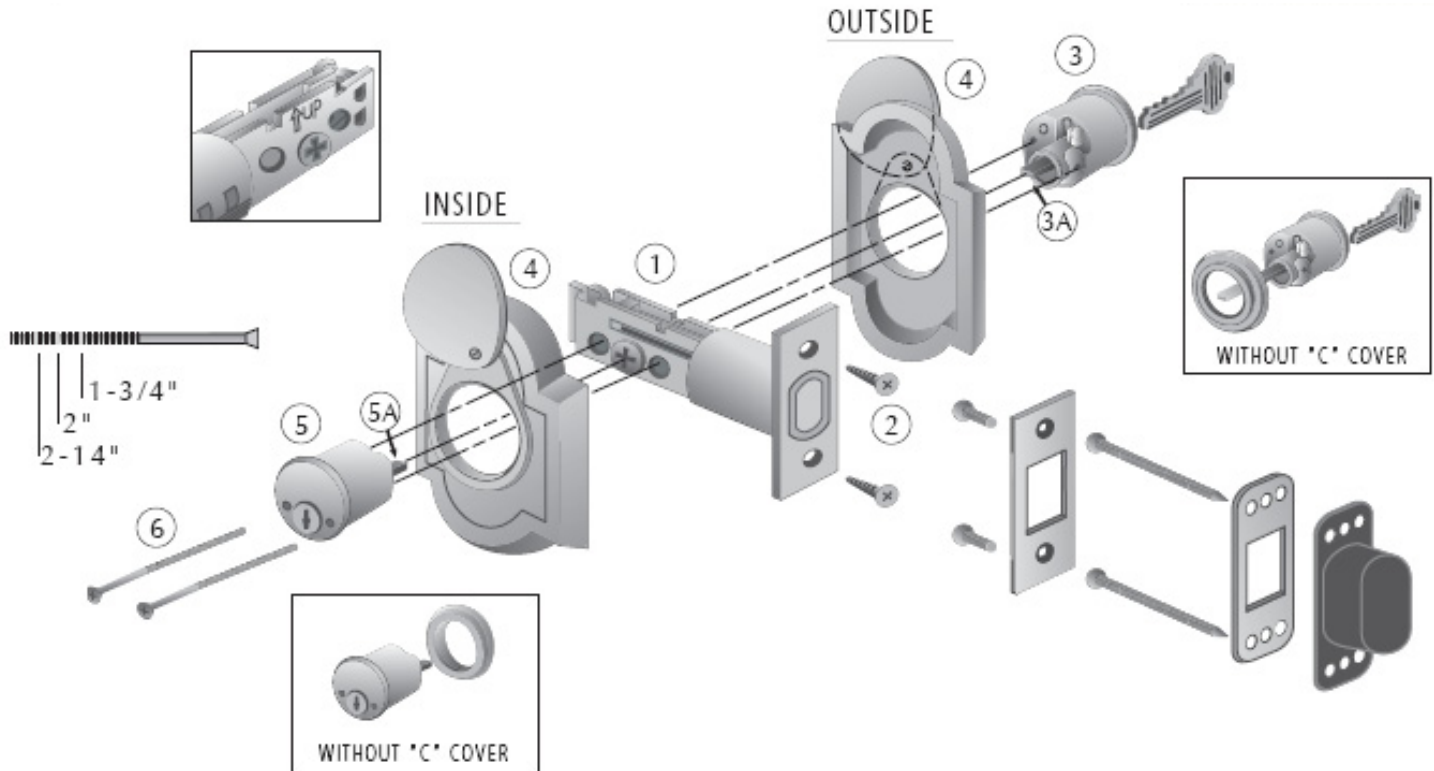

850, 851, 853, 855 DEADBOLT

DEADBOLT:

- A. Install deadbolt (1) with the arrow on the bolt facing up. (Caption) Fasten with screws (2). Pre-drill for screws using 1/8" drill bit.
- B. With a screwdriver or similar tool, turn the deadbolt hub so that the bolt is in the protracted (out) position.

TRIM:

- C. Snap off the two screws (6) to the appropriate length for the thickness of your door.
- D. Take the outside cylinder (3) (The one without the two screw holes on the cylinder face) and turn the tailpiece (3A) to the vertical position.
- E. Repeat the procedure on the inside trim (4) and then insert the two screws (6) through the inside cylinder (5) and gently tighten. Hold outside cylinder and tailpiece (5A) in the proper orientation to get the screws (6) to mate with the outside cylinder. The tailpieces will overlap where they meet in the hub of the bolt (1). Make sure that the cylinders work properly with the keys. Tighten screws (6).
- F. Install the dust box, reinforcing plate, and strike on the jamb. Pre-drill for the 3" long wood screws using 1/8" drill bit.