

# INSTALLATION INSTRUCTIONS

Seamless Transaction with Enhanced Product Features delivered on time and quality correct.

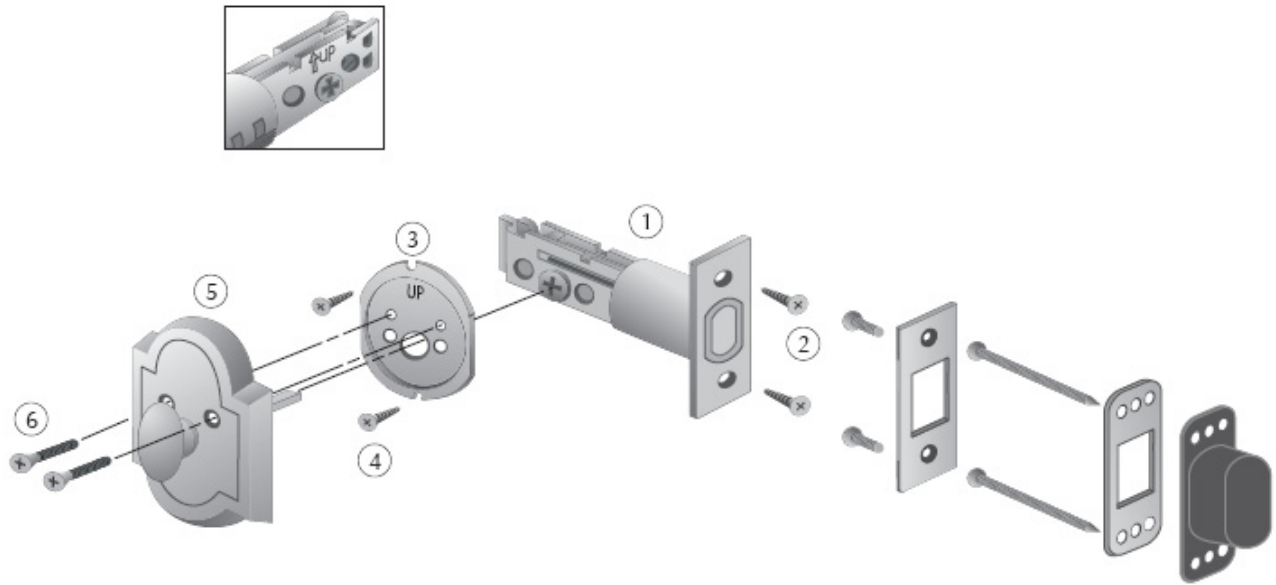

## 820, 821, 823, 825 DEADBOLT

- A. Install deadbolt (1) into the bore with arrow on deadbolt facing up. (Caption) Fasten with screws (2). Pre-drill for screws using 1/8" drill bit.
- B. With a screwdriver or similar tool, turn the hub so that the bolt is in the protracted (out) position.
- C. Place subplate (3) into the 1-1/2" bore on the inside of the door and fasten to the door through the notches on the top and bottom of the subplate with the two screws (4). Pre-drill for screws using 1/8" drill bit.
- D. Install inside trim (5) making sure that the tailpiece engages into the bolt. Install the two machine screws (6) to fix the plate to the door.
- E. Install the dust box, reinforcing plate, and strike on the jamb. Pre-drill for the 3" long wood screws using a 1/8" drill bit.