

INSTALLATION INSTRUCTIONS

Seamless Transaction with Enhanced Product Features delivered on time and quality correct.

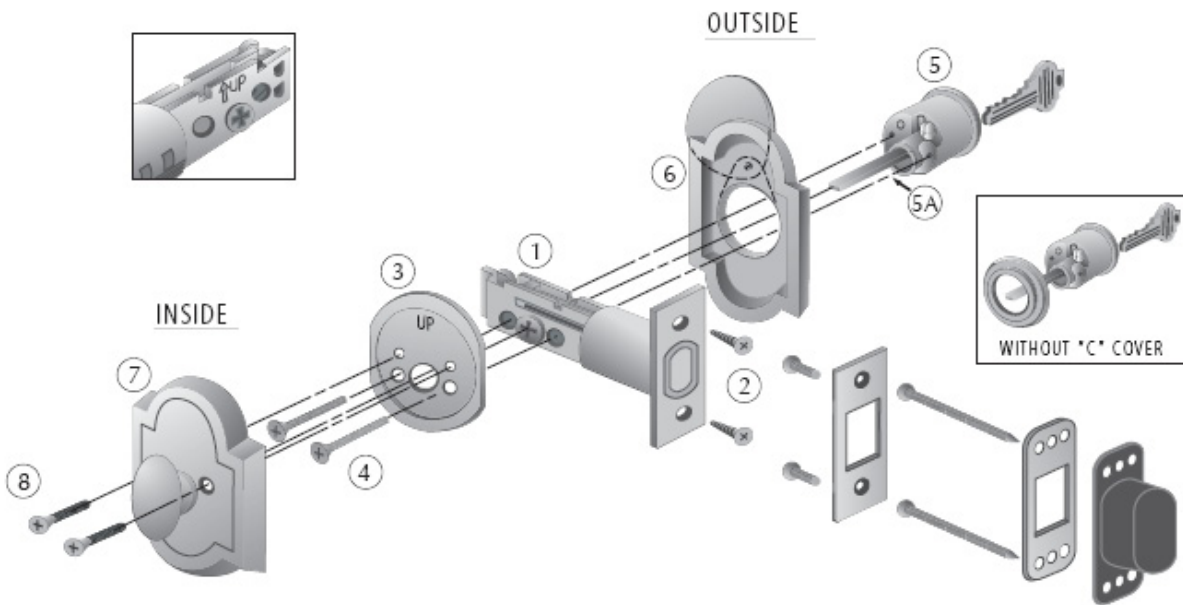

800, 801, 803, 805 DEADBOLT

DEADBOLT:

- A. Install deadbolt (1) with arrow on deadbolt facing up. (Caption)
Fasten with screws (2). Pre-drill using a 1/8" drill bit.
- B. With a screwdriver or similar tool, turn the deadbolt hub so that the bolt is in the protracted (out) position.

TRIM AND CYLINDER:

- C. Slip the cylinder (5) through the outside trim plate (6).
- D. Rotate the tailpiece (5A) to the vertical position and slip the tailpiece into the bolt hub.
- E. Install subplate (3) using machine screws (4). The machine screws pass through the deadbolt (1) and thread into the back of the cylinder (5). Make sure the bolt operates smoothly with the key. Tighten screws (4).
- F. Install the inside trim (7) with the two screws (8). Make sure that the bolt operates smoothly with the turnpiece. Tighten screws (8).
- G. Install the dust box, reinforcing plate, and strike on the jamb. Pre-drill for long wood screws using a 1/8" drill bit.