



LONGLEAF  
COLLECTION

# INSTALLATION INSTRUCTIONS

Seamless Transaction with Enhanced Product Features delivered on time and quality correct.

## 20 FUNCTION

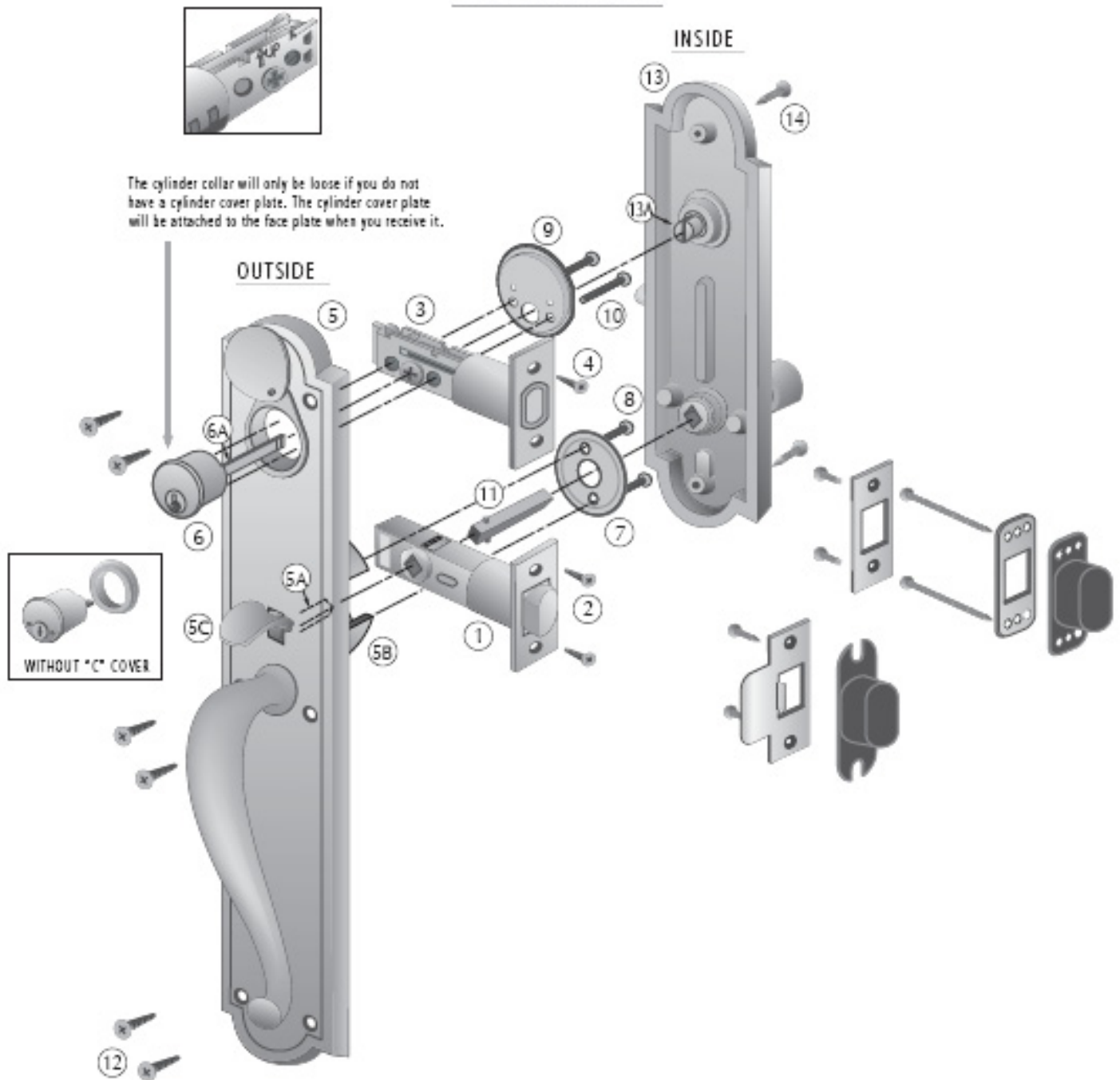

Corporate Address: 9546 Hwy 211 East - Aberdeen, NC 28315  
Mailing Address: PO Box 367 - Aberdeen, NC 28315  
Telephone: 866-635-7155  
Website: [www.longleafcollection.com](http://www.longleafcollection.com)  
Made in the USA

# INSTALLATION INSTRUCTIONS



Seamless Transaction with Enhanced Product Features delivered on time and quality correct.

## 20 FUNCTION

### LATCH:

- A. Insert the latch (1) into the edge of the bore. Make sure that the bevel on the latch tongue is facing the jamb.  
(The latch face is removable so that the bevel can be reversed to maintain the "up" position of the latch.  
Attach latch with screws (2). Pre-drill using a 1/8" drill bit.

### DEADBOLT LATCH:

- B. Install the deadbolt (3) into the top bore with the arrow on the deadbolt facing up (Caption).  
Fasten with screws (4). Pre-drill as per above.
- C. With a screwdriver or similar tool, turn the deadbolt hub so that the bolt is in the protracted (out) position.

### TRIM:

- D. Outside Trim– Place the outside trim (5), on outside of door fitting spindle (5A) into the latch (1) hub.
- E. Install the subplate (7) using machine screws (8) affixing to housing (5B). Make sure that the thumbpiece (5C) operates the latch smoothly, do not tighten screws yet.
- F. Align the edge of the trim (5) parallel to door and securely tighten screws (8) to the outside trim (5).
- G. Insert cylinder (6) through the outside trim (5). Deadbolt (3) must be in the protracted (out) position and the tailpiece (6A) in the vertical position. Insert tailpiece (6A) into the deadbolt hub (3).
- H. Hold the subplate (9) against the inside door bore and fasten to cylinder (6) with machine screws (10).  
Check for smooth operation of the deadbolt (3) using key, and tighten machine screws (10).
- I. Align edge of outside trim (5) parallel with edge of door, and position for free and smooth operation of latch by thumbpiece, and deadbolt by key. Affix to the door with screws (12). Pre-drill for screws using a #5 VIX bit. (If you do not have one, use a 3/32" drill bit to pilot the holes.) Hand tighten the screws, a power driver may strip them.
- J. Inside Trim – From the inside, install short end of spindle (11) on the diamond with notches into latch hub (1) as shown.
- K. Attach inside trim (13) inserting spindle (11) into knob or lever, and tailpiece (6A) into thumbturn (13A).
- L. Align edge of trim (13) with edge of door and position plate by checking free and smooth operations of latch and deadbolt.
- M. Fasten trim to inside of door using screws (14). We recommend the use of a #5 VIX bit to pilot the screw holes for these screws. (If you do not have one, use a 3/32" drill bit to pilot the holes.) Hand tighten the screws, a power driver may strip them.
- N. Install strikes and dust boxes to jamb. Pre-drill for 3" wood screws using a 1/8" drill bit.