

# INSTALLATION INSTRUCTIONS

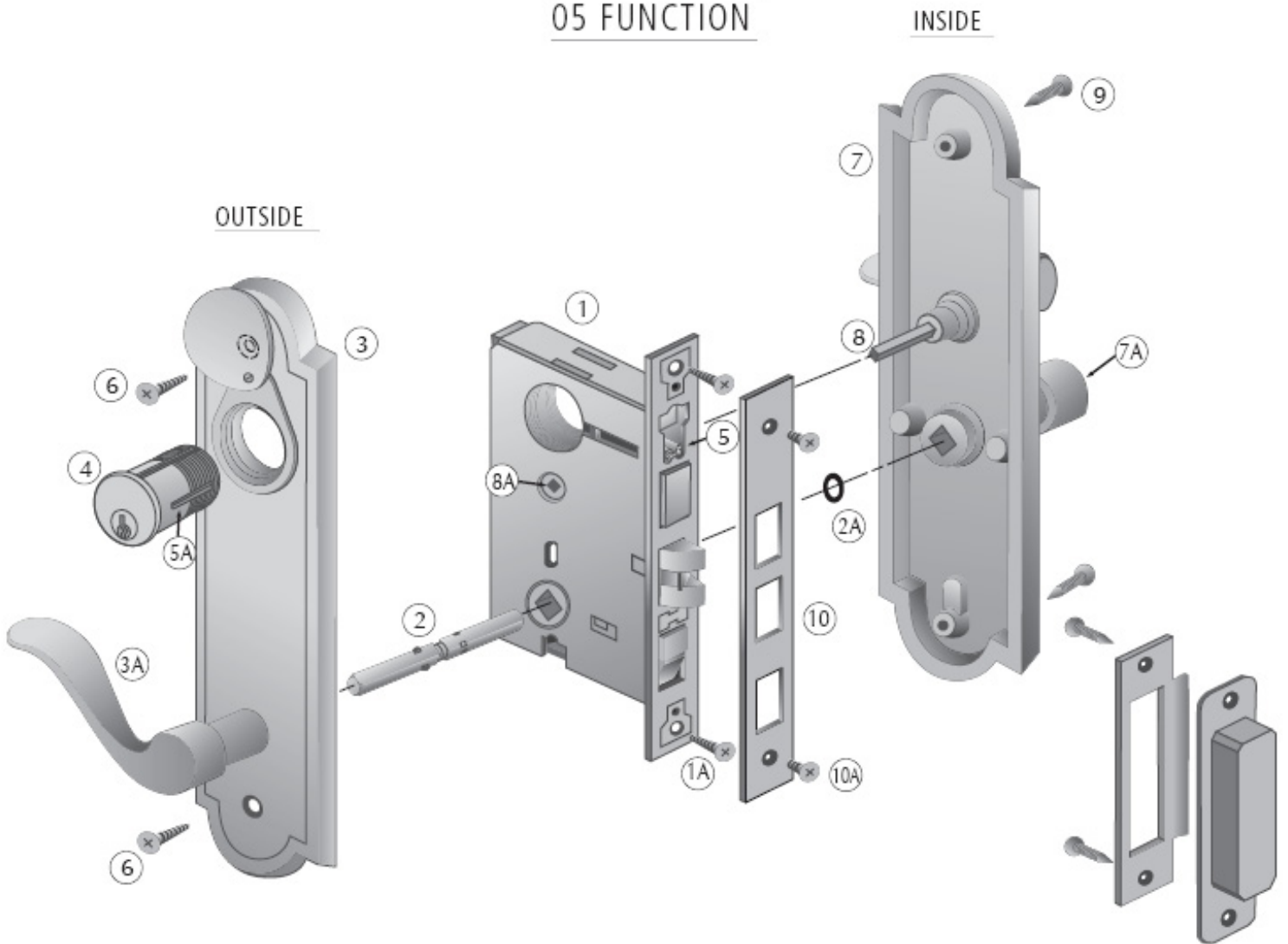

Seamless Transaction with Enhanced Product Features delivered on time and quality correct.

## 05 FUNCTION



Corporate Address: 9546 Hwy 211 East - Aberdeen, NC 28315  
Mailing Address: PO Box 367 - Aberdeen, NC 28315  
Telephone: 866-635-7155  
Website: [www.longleafcollection.com](http://www.longleafcollection.com)  
Made in the USA

# INSTALLATION INSTRUCTIONS



Seamless Transaction with Enhanced Product Features delivered on time and quality correct.

## 05 FUNCTION

- A. Use the template provided to mortise the door.
- B. Install the mortise box (1) using wood screws (1A) being careful that the box is properly aligned. Pre-drill for screws using 1/8" drill bit.
- C. Slide the spindle (2), oriented in the diamond position through the hub of the mortise box. Roll O-ring(2A) over the spindle from the opposite side, seating the O-ring in the spindle groove.
- D. Slide the outside trim (3) onto the spindle. Make sure that the cylinder retaining screw(5) is backed out of the threaded area on the lock and insert the cylinder (4) through the plate (3) and thread into the mortise box (1) until it is firmly seated in the plate. The key slot should be positioned at 6 o'clock. You can use your key to adjust the cylinder by inserting it fully and then pulling it out one step.
- E. When the cylinder (4) is located properly, it can be positioned by threading screw (5) on the face of the mortise box (above the deadbolt mechanism) into the groove (5A) machined in the cylinder. The key can now be removed.
- F. Adjust the position of the plate to allow for free and smooth operation of the latch by knob or lever and of the deadbolt by the key.
- G. Holding the plate parallel with the edge of the door, locate the holes for the two trim screws (6). We recommend the use of a #5 VIX bit to pilot the screw holes for these screws. (If you do not have one, use a 3/32" drive bit to pilot the holes.) Hand tighten the screws as a power driver may strip them.

### INSIDE TRIM:

- H. Cut the tailpiece (8) to the proper length for your door thickness.
- I. Place the inside plate (7) on the face of the door. While inserting the tailpiece (8) into the hub in the mortise box, make sure that the tailpiece is in the vertical position, and slide the lever or knob (7A) onto the spindle (2).
- J. Align the edge of the inside plate (7) parallel with the edge of the door and adjust the position for free and smooth operation of the latch by lever, and deadbolt by turnpiece.
- K. Holding the plate parallel with the edge of the door, locate the holes for the two trim screws (9). We recommend the use of a #5 VIX bit to pilot the screw holes for these screws. (If you do not have one, use a 3/32" drive bit to pilot the holes.) Hand tighten the screws as a power driver may strip them.
- L. Install the mortise box face plate (10) onto the mortise box using the short machine screws (10A).
- M. Install the strike plate and dust box. Pre-drill for screws using a 1/8" drill bit.