

INSTALLATION INSTRUCTIONS

Seamless Transaction with Enhanced Product Features delivered on time and quality correct.

04 FUNCTION

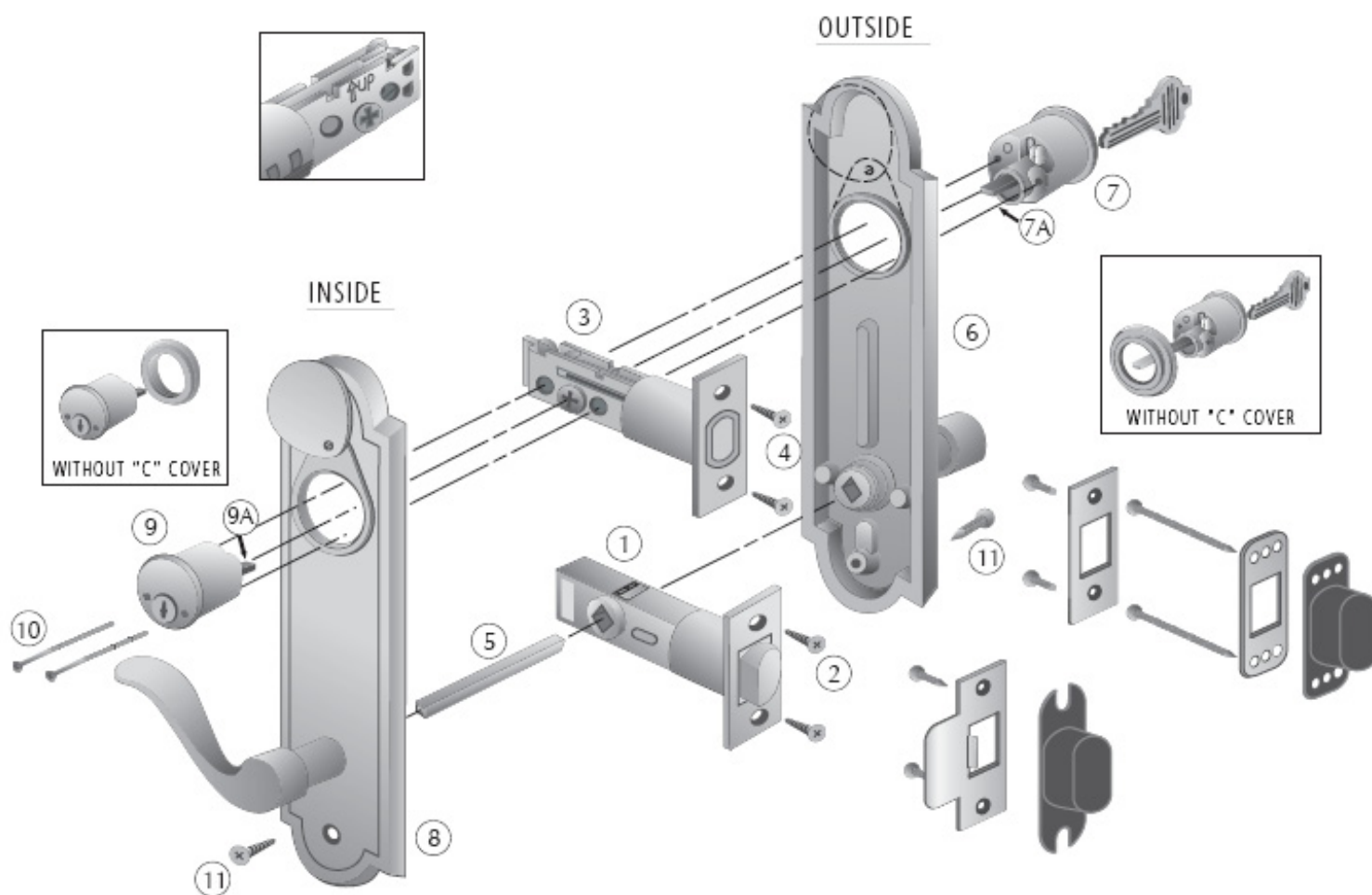

INSTALLATION INSTRUCTIONS

Seamless Transaction with Enhanced Product Features delivered on time and quality correct.

04 FUNCTION

Latch:

- A. Insert the latch (1) into the edge of the bore. Make sure the bevel on the latch tongue is facing the jamb. (The latch face is removable so that the bevel can be reversed to maintain the "up" position of the latch.) Attach latch with screws (2). Pre-drill for screws using a 1/8" drill bit.
- B. Install the strike and dust box to the jamb. Pre-drill for screws using a 1/8" drill bit.

DEADBOLT:

- C. Install deadbolt latch (3) into the top bore with arrow on deadbolt facing up (Caption). Fasten with screws (4). Pre-drill as per above.
- D. With a screwdriver or similar tool, turn the deadbolt hub (3) so that the bolt is in the protracted (out) position.

TRIM:

- E. Outside Trim - Slip the spindle (5) oriented in the diamond position through the latch hub (1).
- F. Place the outside trim (6) onto the outside of the door and insert spindle (5) into the knob or lever of the outside trim (6).
- G. Insert the outside cylinder (7) through the outside trim (6) with the tailpiece (7A) rotated to the vertical position and insert into the deadbolt hub (3). The outside cylinder has no visible holes on its face; the inside cylinder (9) has two holes on its face. The machine screws (10) will thread through the inside cylinder (9) into the backside of the outside cylinder (7).
- H. Inside Trim - Place the inside trimplate (8) so that the spindle (5) fits into the lever or knob.
- I. Rotate the tailpiece (9A) of the inside cylinder vertically and fit into the deadbolt hub (3). The tailpieces will overlap where they meet in the hub of the bolt (1).
- J. Insert machine screws (10) through the inside cylinder (9) and screw into the back of the outside cylinder (7).
- K. Align the plates parallel with the edge of the door. Before tightening the deadbolt machine screws (10), check for free and smooth operation of the deadbolt with key on inside and outside.
- L. Making sure that the plates are parallel with the edge of the door, install the four wood screws (11) to affix the plates to the door. We recommend the use of a #5 VIX bit to pilot the screw holes for these screws. (If you do not have one, use a 3/32 drive bit to pilot the holes.) Hand tighten the screws as a power driver may strip them.
- M. Install the dust box, jamb reinforcing plate and strike for the deadbolt on the jamb. Pre-drill for the 3" long wood screws using a 1/8" drill bit.