

INSTALLATION INSTRUCTIONS

Seamless Transaction with Enhanced Product Features delivered on time and quality correct.

03 FUNCTION

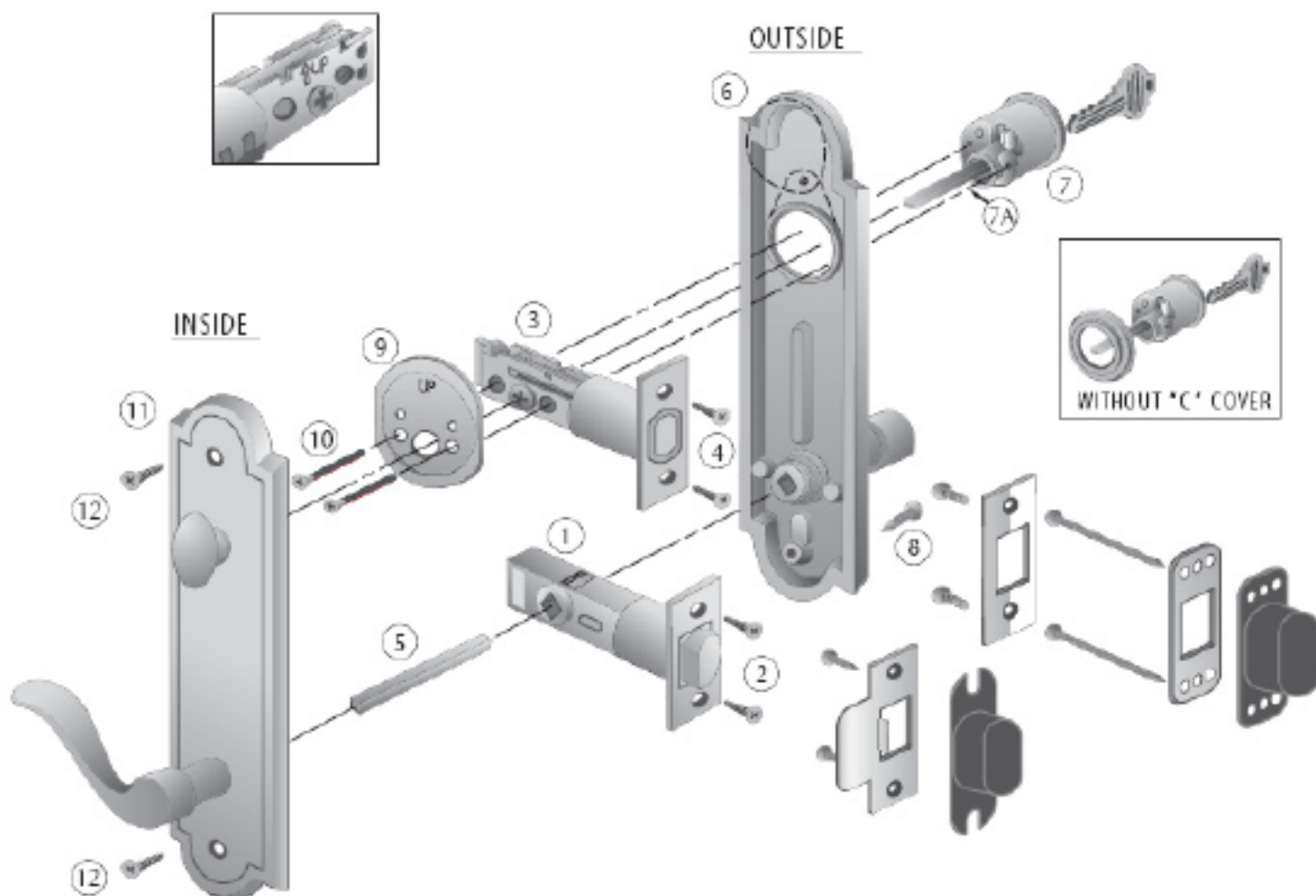

INSTALLATION INSTRUCTIONS

Seamless Transaction with Enhanced Product Features delivered on time and quality correct.

03 FUNCTION

- A. Insert the latch (1) into the edge of the bore. Make sure the bevel on the latch tongue is facing the jamb.
(The latch face is removable so that the bevel can be reversed to maintain the "up" position of the latch.)
Attach latch with screws (2). Pre-drill for screws using a 1/8" drill bit.
- B. Install the strike and dust box to the jamb. Pre-drill for screws using a 1/8" drill bit.

DEADBOLT:

- C. Install deadbolt latch (3) into the top bore with arrow on deadbolt facing up (Caption).
Fasten with screws (4). Pre-drill as per above.
- D. With a screwdriver or similar tool, turn the deadbolt hub (3) so that the bolt is in the protracted (out) position.

TRIM:

- E. Outside Trim - Slip the spindle (5) through the latch hub (1). Orient the spindle in the diamond position.
- F. Place outside trim (6) onto the outside of the door and insert spindle (5) into the knob or lever of the outside trim.
- G. Insert the cylinder (7) through the outside trim (6) with the tailpiece (7A) rotated to the vertical position, and insert into the deadbolt hub (3).
- H. Hold subplate (9) to inside bore door, and fasten to cylinder (7) using machine screws (10).
- I. Test for free and smooth operation of deadbolt by using key in cylinder (7). When properly aligned, tighten screws (10).
- J. Align edge of trim parallel with edge of door, while checking for free and smooth operation of latch by knob or lever. When outside trim is properly positioned, fasten to door with trim screw (8). We recommend the use of a #5 VIX bit to pilot the screw holes for these screws. (If you do not have one, use a 3/32 drive bit to pilot the holes.) Hand tighten the screws as a power driver may strip them.
- K. Attach inside trim (11) inserting spindle (5) into knob or lever, and tailpiece (7A) into thumbturn.
- L. Align edge of trim (11) parallel with edge of door, and position plate by checking for free and smooth operations of the latch and deadbolt.
- M. Fasten trim to inside of door using screws (12). We recommend the use of a #5 VIX bit to pilot the screw holes for these screws. (If you do not have one, use a 3/32" drill bit to pilot the holes.) Hand tighten the screws, a power drill may strip them.
- N. Install the dust box, jamb reinforcing plate, and strike for the deadbolt on the jamb. Pre-drill for 3" wood screws using a 1/8" drill bit.